

Soils Map

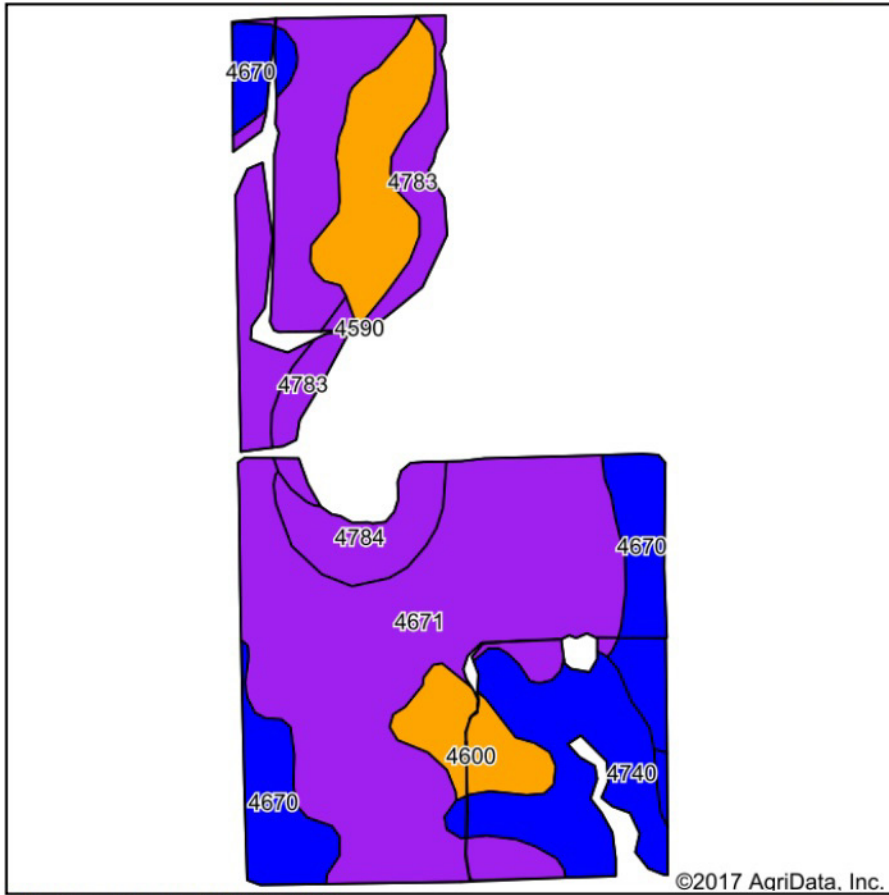

Soils data provided by USDA and NRCS.

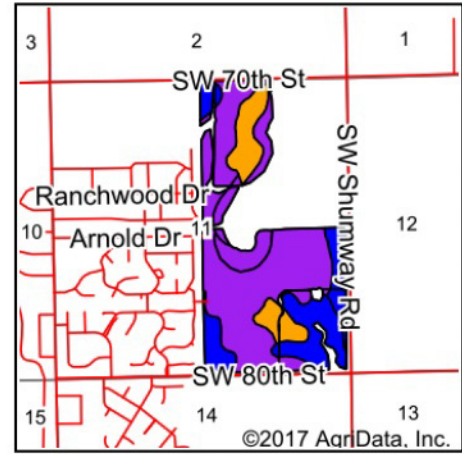

State: **Kansas**
 County: **Butler**
 Location: **11-27S-4E**
 Township: **Augusta**
 Acres: **197.69**
 Date: **1/12/2018**



Area Symbol: KS015, Soil Area Version: 15

Code	Soil Description	Acres	Percent of field	Non-Irr Class Legend	Non-Irr Class *c	Irr Class *c
4671	Irwin silty clay loam, 1 to 3 percent slopes	104.17	52.7%		IIIIs	IIIIs
4670	Irwin silty clay loam, 0 to 1 percent slopes	24.00	12.1%		IIs	IIs
4740	Labette silty clay loam, 1 to 3 percent slopes	22.76	11.5%		Ile	Ile
4674	Irwin silty clay loam, 3 to 7 percent slopes, eroded	15.83	8.0%		IVe	IVe
4783	Tully silty clay loam, 3 to 7 percent slopes	11.16	5.6%		IIIe	IIIe
4600	Dwight silt loam, 0 to 1 percent slopes	9.83	5.0%		IVs	IVs
4784	Tully silty clay loam, 3 to 7 percent slopes, eroded	9.37	4.7%		IIIe	IIIe
4744	Labette-Dwight complex, 0 to 3 percent slopes	0.57	0.3%		Ile	Ile

*c: Using Capabilities Class Dominant Condition Aggregation Method

Soils data provided by USDA and NRCS.