

Soils Map

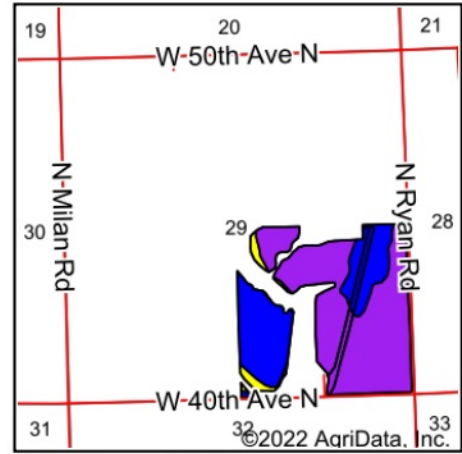

State: **Kansas**
 County: **Sumner**
 Location: **29-31S-3W**
 Township: **Springdale**
 Acres: **119.44**
 Date: **4/12/2022**

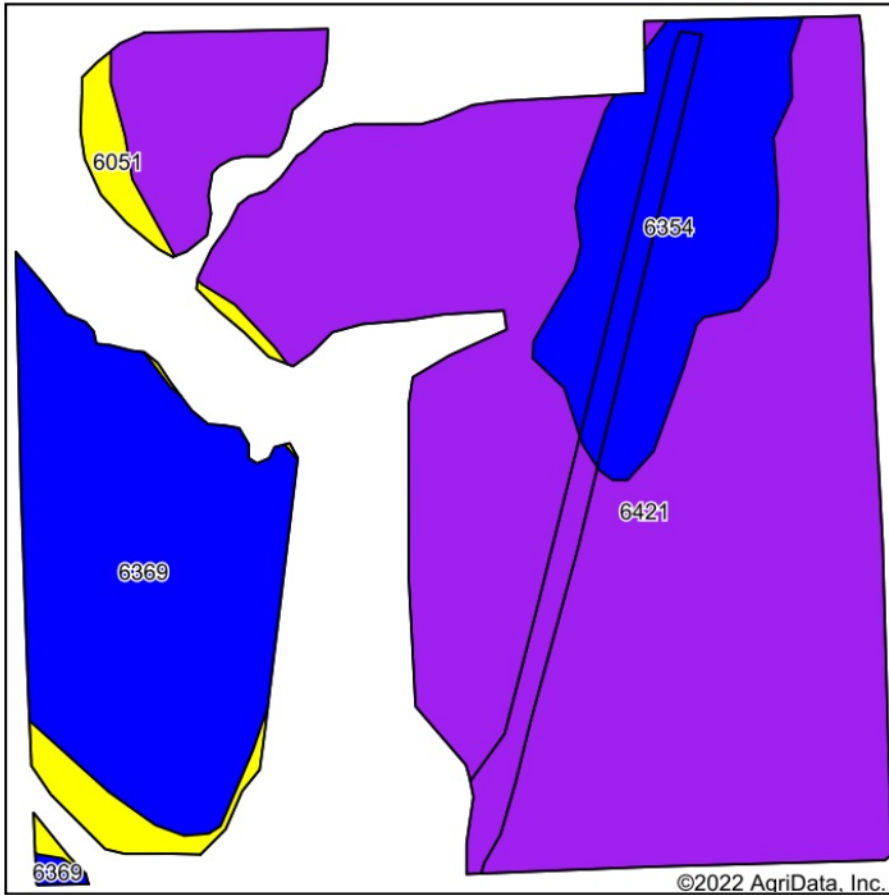

Soils data provided by USDA and NRCS.

Area Symbol: KS191, Soil Area Version: 18

Code	Soil Description	Acres	Percent of field	Non-Irr Class Legend	Non-Irr Class *c	Irr Class *c	Alfalfa hay Irrigated Tons	Barley Bu	Corn Bu	Corn Irrigated Bu	Cotton lint Lbs	Grain sorghum Bu	Grain sorghum Irrigated Bu	Improved bermudagrass AUM	Introduced bluestem AUM	Oat Bu		
6421	Renfrow-Grainola complex, 1 to 3 percent slopes	77.01	64.5%		IIIe							32			3			
6369	Milan loam, 1 to 3 percent slopes	23.43	19.6%		Ile	Ile	7		59	149		50	109					
6354	Kirkland silt loam, 0 to 1 percent slopes, cool	15.24	12.8%		IIs	IIs		4			22	35		4	5	3		
6051	Elandco silt loam, frequently flooded	3.76	3.1%		Vw													
Weighted Average							2.74	0.65	1.4	0.5	11.6	29.2	2.8	34.9	21.4	2.4	0.6	4

*n: The aggregation method is "Weighted Average using all components"

*c: Using Capabilities Class Dominant Condition Aggregation Method

Soils data provided by USDA and NRCS.