

Soils Map

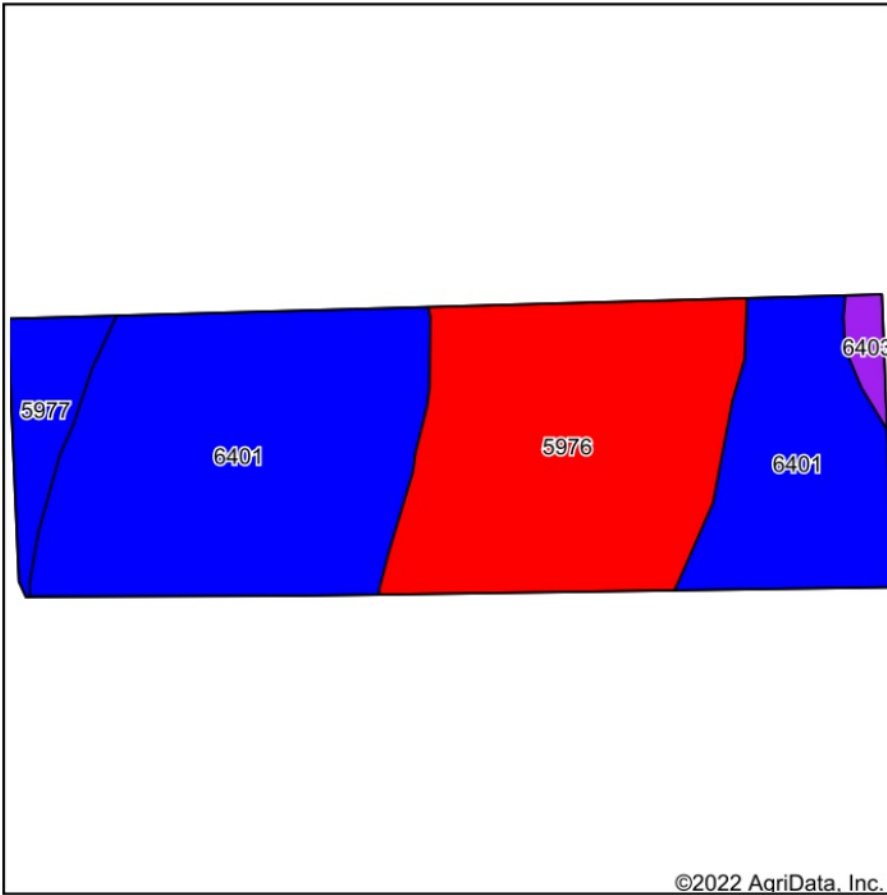

Soils data provided by USDA and NRCS.

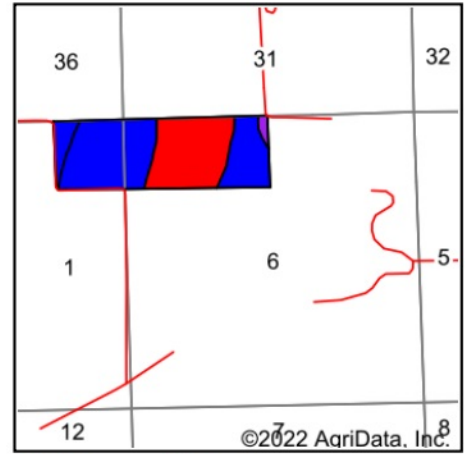

State: **Kansas**
 County: **Cowley**
 Location: **6-34S-5E**
 Township: **Pleasant Valley**
 Acres: **114.29**
 Date: **6/22/2022**



Area Symbol: KS035, Soil Area Version: 18

Code	Soil Description	Acres	Percent of field	Non-Irr Class Legend	Non-Irr Class *c	Irr Class *c	*n NCCPI Soybeans
6401	Norge silt loam, 1 to 3 percent slopes	65.47	57.3%		Ile	Ile	78
5976	Vanoss silt loam, 0 to 1 percent slopes	40.63	35.5%		Ic	Is	73
5977	Vanoss silt loam, 1 to 3 percent slopes	6.45	5.6%		Ile	Ile	73
6403	Norge silty clay loam, 3 to 7 percent slopes, eroded	1.74	1.5%		IIle	IIle	69
Weighted Average					1.66	1.66	*n 75.8

*n: The aggregation method is "Weighted Average using all components"

*c: Using Capabilities Class Dominant Condition Aggregation Method