

# Soils Map

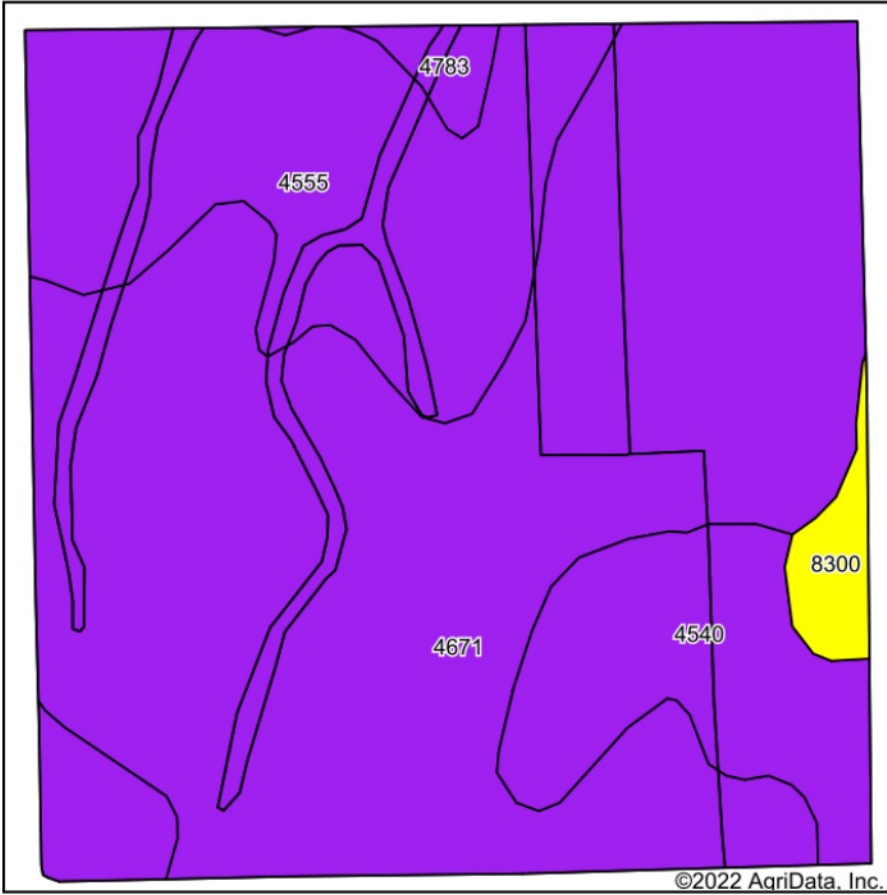

Soils data provided by USDA and NRCS.

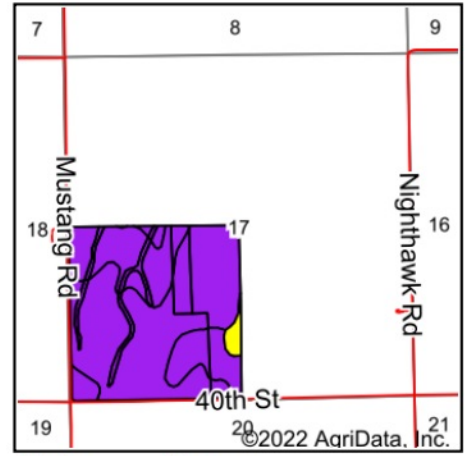

State: **Kansas**  
 County: **Marion**  
 Location: **17-22S-3E**  
 Township: **Peabody**  
 Acres: **160.61**  
 Date: **11/14/2022**



Area Symbol: KS115, Soil Area Version: 20

Code	Soil Description	Acres	Percent of field	Non-Irr Class Legend	Non-Irr Class *c	Irr Class *c	*n NCCPI Soybeans
4671	Irwin silty clay loam, 1 to 3 percent slopes	102.12	63.6%			IIIIs	55
4555	Clime silty clay loam, 3 to 7 percent slopes	36.66	22.8%			IIIle	43
4540	Clime silty clay loam, 1 to 3 percent slopes	16.85	10.5%			IIIle	43
8300	Verdigris silt loam, channeled, 0 to 2 percent slopes, frequently flooded	2.99	1.9%			Vw	41
4783	Tully silty clay loam, 3 to 7 percent slopes	1.99	1.2%			IIIle	60
<b>Weighted Average</b>					<b>3.04</b>	<b>*-</b>	<b>*n 50.8</b>

\*n: The aggregation method is "Weighted Average using all components"

\*c: Using Capabilities Class Dominant Condition Aggregation Method

\*- Irr Class weighted average cannot be calculated on the current soils data due to missing data.