

Soils Map

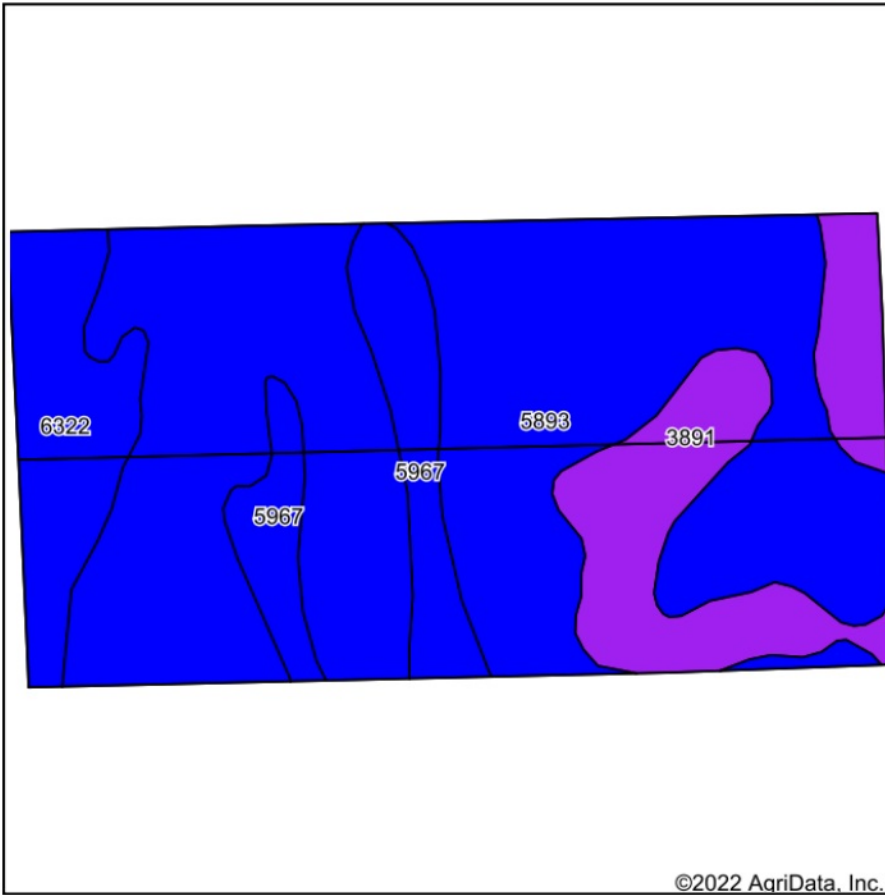

Soils data provided by USDA and NRCS.

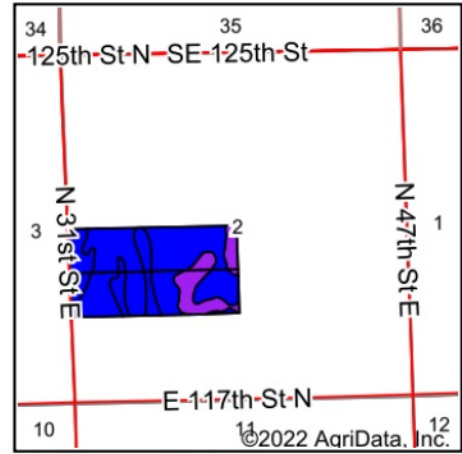

State: **Kansas**
 County: **Sedgwick**
 Location: **2-25S-1E**
 Township: **Grant**
 Acres: **82.42**
 Date: **10/11/2022**



Area Symbol: KS173, Soil Area Version: 17

Code	Soil Description	Acres	Percent of field	Non-Irr Class Legend	Non-Irr Class *c	Irr Class *c	Range Production (lbs/acre/yr)	*n NCCPI Soybeans
5893	Farnum loam, 1 to 3 percent slopes	53.70	65.2%		IIc	Is	2550	64
3891	Ladysmith silty clay loam, 1 to 3 percent slopes	12.48	15.1%		IIIIs	IIIIs	4425	51
5967	Tabler silty clay loam, 0 to 1 percent slopes	8.15	9.9%		IIIs	IIIs	2640	56
6322	Blanket silt loam, 0 to 1 percent slopes	8.09	9.8%		IIc	Is	2805	64
Weighted Average					2.15	1.40	2867.8	*n 61.2

*n: The aggregation method is "Weighted Average using all components"

*c: Using Capabilities Class Dominant Condition Aggregation Method