

# Soils Map

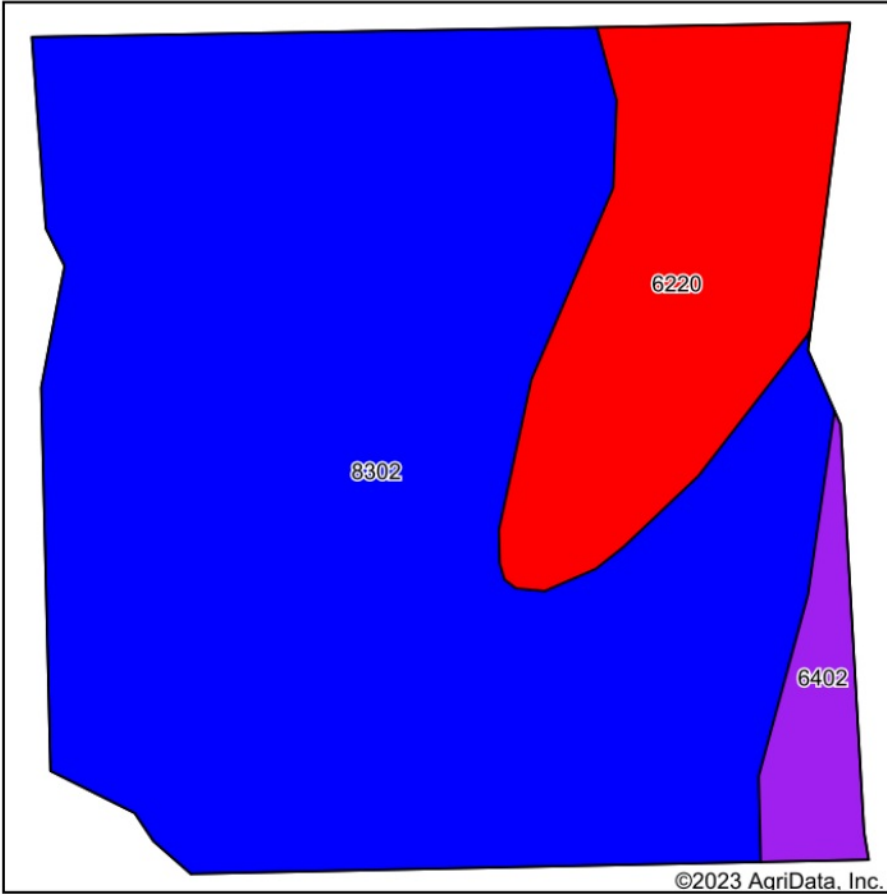

Soils data provided by USDA and NRCS.

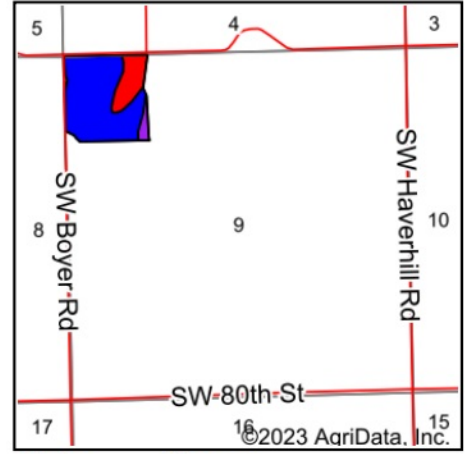

State: **Kansas**  
 County: **Butler**  
 Location: **9-27S-5E**  
 Township: **Spring**  
 Acres: **37.37**  
 Date: **4/13/2023**



Area Symbol: KS015, Soil Area Version: 20							
Code	Soil Description	Acres	Percent of field	Non-Irr Class Legend	Non-Irr Class *c	Irr Class *c	*n NCCPI Soybeans
8302	Verdigris silt loam, 0 to 1 percent slopes, occasionally flooded	29.14	78.0%		IIw		82
6220	Brewer silty clay loam, rarely flooded	6.74	18.0%		Iw	Iw	63
6402	Norge silt loam, 3 to 7 percent slopes	1.49	4.0%		IIIe	IIIe	76
<b>Weighted Average</b>					<b>1.86</b>	<b>*-</b>	<b>*n 78.3</b>

\*n: The aggregation method is "Weighted Average using all components"

\*c: Using Capabilities Class Dominant Condition Aggregation Method

\*- Irr Class weighted average cannot be calculated on the current soils data due to missing data.