

# Soils Map

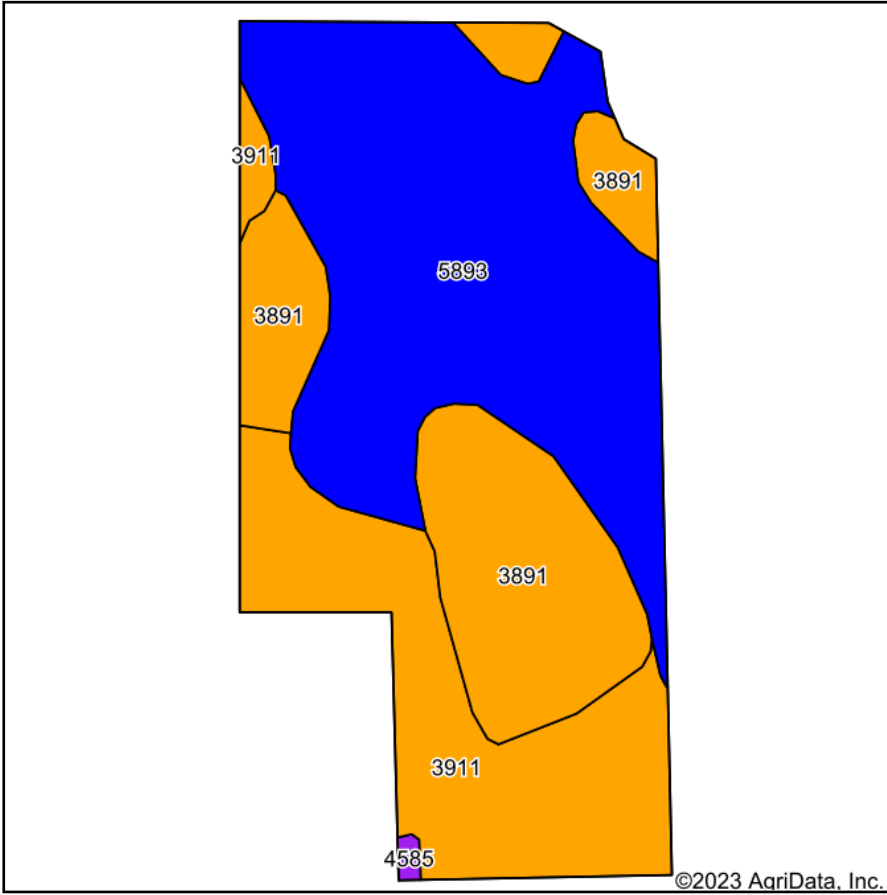

Soils data provided by USDA and NRCS.

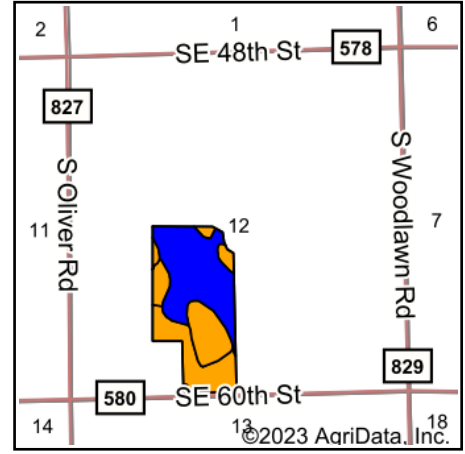

State: **Kansas**  
 County: **Harvey**  
 Location: **12-24S-1E**  
 Township: **Darlington**  
 Acres: **64.65**  
 Date: **7/18/2023**



Area Symbol: KS079, Soil Area Version: 19

Code	Soil Description	Acres	Percent of field	Non-Irr Class Legend	Non-Irr Class *c	Irr Class *c	Range Production (lbs/acre/yr)	*n NCCPI Overall	*n NCCPI Corn	*n NCCPI Small Grains	*n NCCPI Soybeans	*n NCCPI Cotton
5893	Farnum loam, 1 to 3 percent slopes	31.53	48.8%		IIc	Is	2550	63	52	48	63	35
3891	Ladysmith silty clay loam, 1 to 3 percent slopes	16.49	25.5%		IIIIs	IIIIs	4425	51	39	43	51	28
3911	Rosehill silty clay, 1 to 3 percent slopes	16.43	25.4%		IIIe	IIIe	3150	42	30	36	42	19
4585	Clime-Hobbs complex, 0 to 20 percent slopes	0.20	0.3%		VIe		4190	42	37	33	42	14
<b>Weighted Average</b>					<b>2.52</b>	<b>*-</b>	<b>3185.8</b>	<b>*n 54.5</b>	<b>*n 43</b>	<b>*n 43.6</b>	<b>*n 54.5</b>	<b>*n 29.1</b>

\*n: The aggregation method is "Weighted Average using all components"

\*c: Using Capabilities Class Dominant Condition Aggregation Method

\*- Irr Class weighted average cannot be calculated on the current soils data due to missing data.

Soils data provided by USDA and NRCS.