

Soils Map

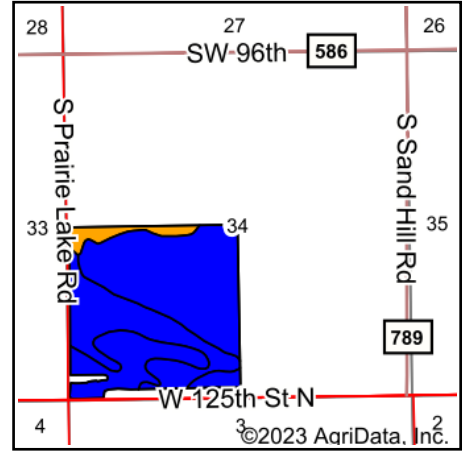

State: **Kansas**
 County: **Harvey**
 Location: **34-24S-3W**
 Township: **Lake**
 Acres: **148.77**
 Date: **7/17/2023**

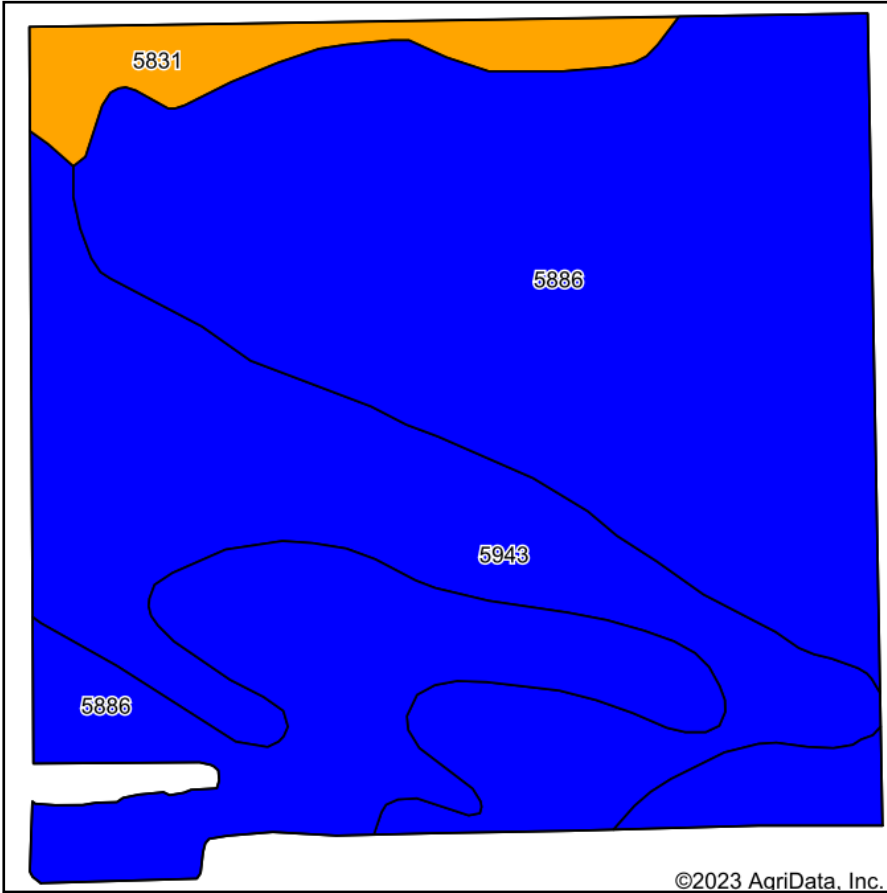

Soils data provided by USDA and NRCS.

Area Symbol: KS079, Soil Area Version: 19

Code	Soil Description	Acres	Percent of field	Non-Irr Class Legend	Non-Irr Class *c	Irr Class *c	Range Production (lbs/acre/yr)	*n NCCPI Overall	*n NCCPI Corn	*n NCCPI Small Grains	*n NCCPI Soybeans	*n NCCPI Cotton
5886	Farnum and Funmar loams, 0 to 1 percent slopes	99.60	66.9%		IIc	Is	2720	62	52	48	62	36
5943	Saltcreek and Naron fine sandy loams, 0 to 1 percent slopes	41.53	27.9%		IIc	Iw	2970	57	44	44	57	22
5831	Punkin silt loam, 0 to 1 percent slopes	7.64	5.1%		IIIc	IIIc	2196	26	7	26	16	12
Weighted Average								*n 58.8	*n 47.5	*n 45.8	*n 58.2	*n 30.9

*n: The aggregation method is "Weighted Average using all components"

*c: Using Capabilities Class Dominant Condition Aggregation Method

Soils data provided by USDA and NRCS.