

# Soils Map

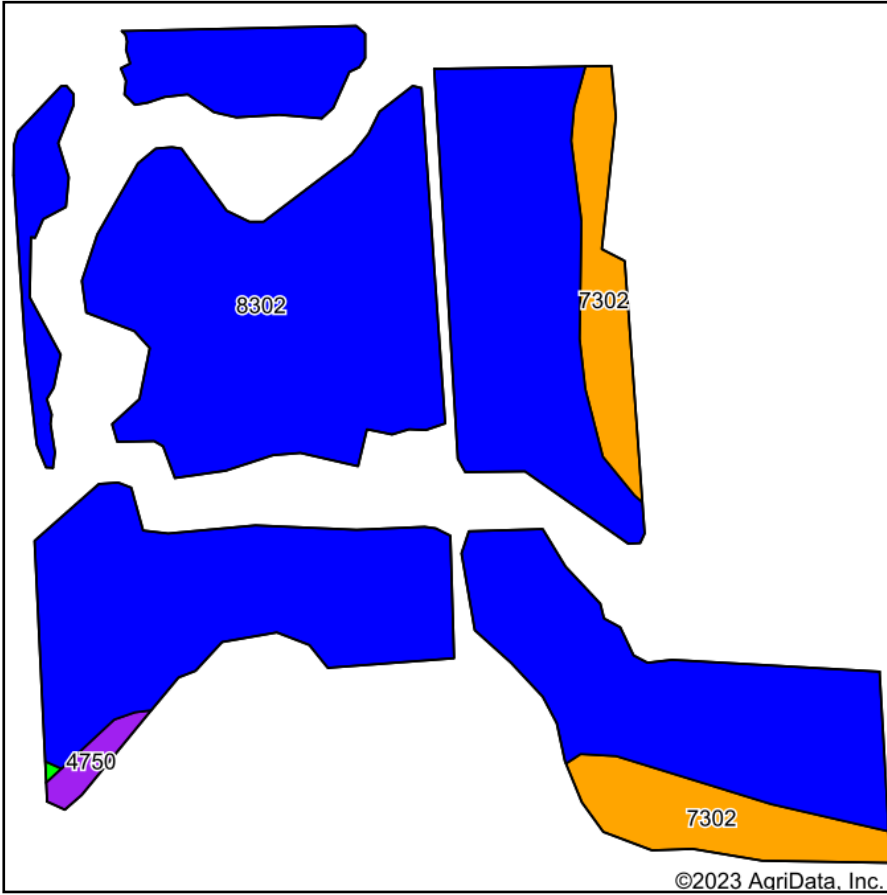

Soils data provided by USDA and NRCS.

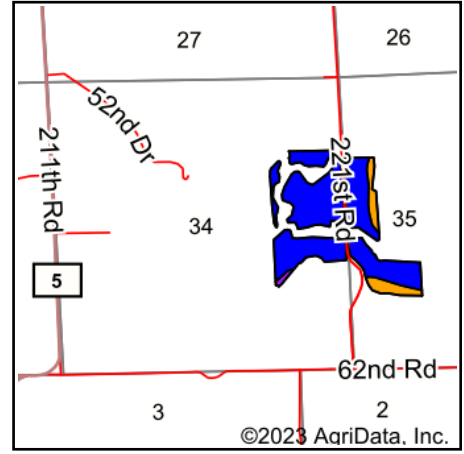

State: **Kansas**  
 County: **Cowley**  
 Location: **35-30S-6E**  
 Township: **Omnia**  
 Acres: **77.52**  
 Date: **9/21/2023**



Area Symbol: KS035, Soil Area Version: 19

Code	Soil Description	Acres	Percent of field	Non-Irr Class Legend	Non-Irr Class *c	Irr Class *c	Range Production (lbs/acre/yr)	*n NCCPI Overall	*n NCCPI Corn	*n NCCPI Small Grains	*n NCCPI Soybeans	*n NCCPI Cotton
8302	Verdigris silt loam, 0 to 1 percent slopes, occasionally flooded	68.73	88.7%		Ilw		7200	82	81	68	82	44
7302	Martin silty clay loam, 3 to 7 percent slopes	8.03	10.4%		Ille	Ille	4250	52	45	51	49	28
4750	Sogn silty clay loam, 0 to 10 percent slopes	0.76	1.0%		Vls		2250	21	20	20	17	9
<b>Weighted Average</b>					<b>2.14</b>	<b>*-</b>	<b>6845.9</b>	<b>*n 78.3</b>	<b>*n 76.7</b>	<b>*n 65.8</b>	<b>*n 77.9</b>	<b>*n 42</b>

\*n: The aggregation method is "Weighted Average using all components"

\*c: Using Capabilities Class Dominant Condition Aggregation Method

\*- Irr Class weighted average cannot be calculated on the current soils data due to missing data.

Soils data provided by USDA and NRCS.