

# Soils Map

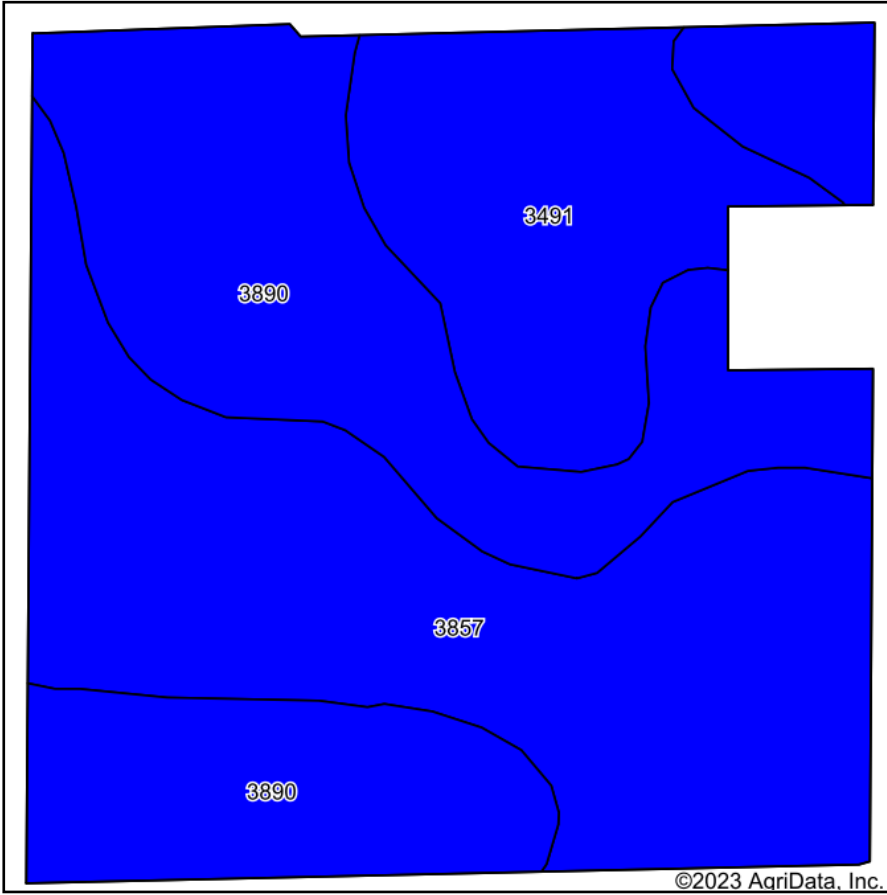

Soils data provided by USDA and NRCS.

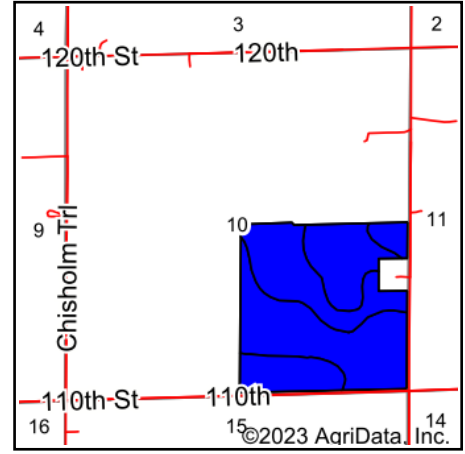

State: **Kansas**  
 County: **Marion**  
 Location: **10-21S-1E**  
 Township: **West Branch**  
 Acres: **147.34**  
 Date: **8/31/2023**



Area Symbol: KS115, Soil Area Version: 20

Code	Soil Description	Acres	Percent of field	Non-Irr Class Legend	Non-Irr Class *c	Irr Class *c	Range Production (lbs/acre/yr)	*n NCCPI Overall	*n NCCPI Corn	*n NCCPI Small Grains	*n NCCPI Soybeans	*n NCCPI Cotton
3890	Ladysmith silty clay loam, 0 to 1 percent slopes	63.10	42.8%		Ils	Ils	4425	51	39	43	51	28
3857	Goessel silty clay, 0 to 1 percent slopes	57.35	38.9%		Ils	Ils	2975	49	37	43	49	25
3491	Wells loam, 1 to 3 percent slopes	26.89	18.3%		Ile	Ile	3750	66	60	54	66	33
<b>Weighted Average</b>					<b>2.00</b>	<b>2.00</b>	<b>3737.4</b>	<b>*n 53</b>	<b>*n 42.1</b>	<b>*n 45</b>	<b>*n 53</b>	<b>*n 27.7</b>

\*n: The aggregation method is "Weighted Average using all components"

\*c: Using Capabilities Class Dominant Condition Aggregation Method

Soils data provided by USDA and NRCS.