

# Soils Map

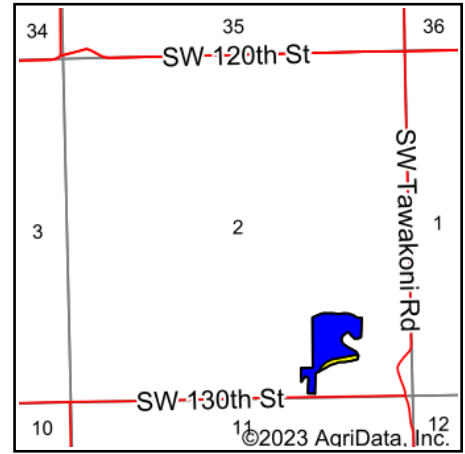

State: **Kansas**  
 County: **Butler**  
 Location: **2-28S-3E**  
 Township: **Pleasant**  
 Acres: **13.11**  
 Date: **10/20/2023**

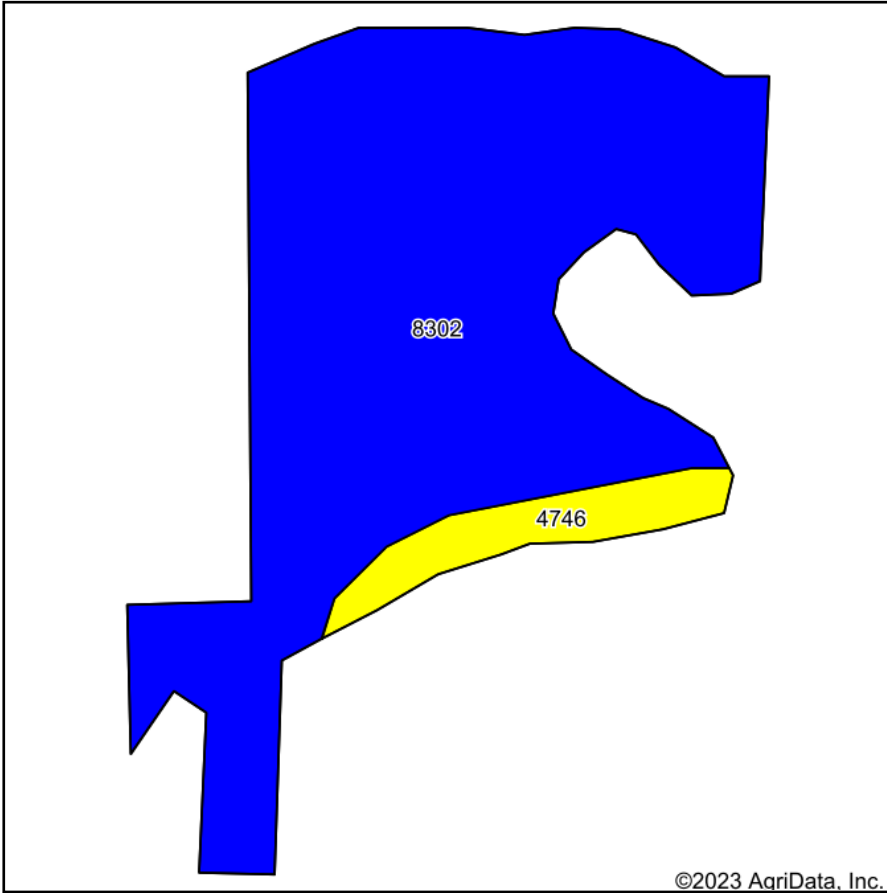

Maps Provided By:



Soils data provided by USDA and NRCS.

©2023 AgriData, Inc.

Area Symbol: KS015, Soil Area Version: 20

Code	Soil Description	Acres	Percent of field	Non-Irr Class Legend	Non-Irr Class *c	Irr Class *c	Range Production (lbs/acre/yr)	*n NCCPI Overall	*n NCCPI Corn	*n NCCPI Small Grains	*n NCCPI Soybeans	*n NCCPI Cotton
8302	Verdigris silt loam, 0 to 1 percent slopes, occasionally flooded	12.11	92.4%		IIw		7200	82	81	68	82	44
4746	Labette-Sogn silty clay loam, 0 to 8 percent slopes	1.00	7.6%		IVe	IIIe	3500	35	32	35	32	19
<b>Weighted Average</b>					<b>2.15</b>	<b>*-</b>	<b>6917.8</b>	<b>*n 78.4</b>	<b>*n 77.3</b>	<b>*n 65.5</b>	<b>*n 78.2</b>	<b>*n 42.1</b>

\*n: The aggregation method is "Weighted Average using all components"

\*c: Using Capabilities Class Dominant Condition Aggregation Method

\*- Irr Class weighted average cannot be calculated on the current soils data due to missing data.

Soils data provided by USDA and NRCS.