

# Soils Map

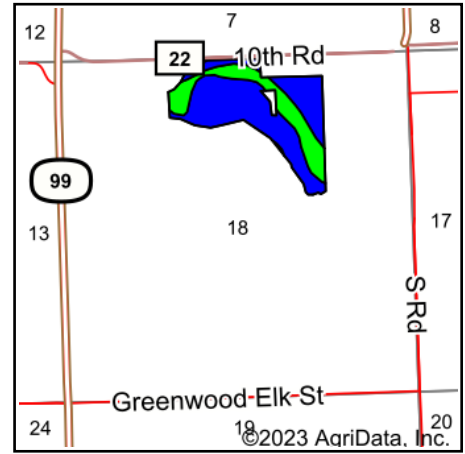

State: **Kansas**  
 County: **Greenwood**  
 Location: **18-28S-11E**  
 Township: **Twin Grove**  
 Acres: **60.7**  
 Date: **10/17/2023**

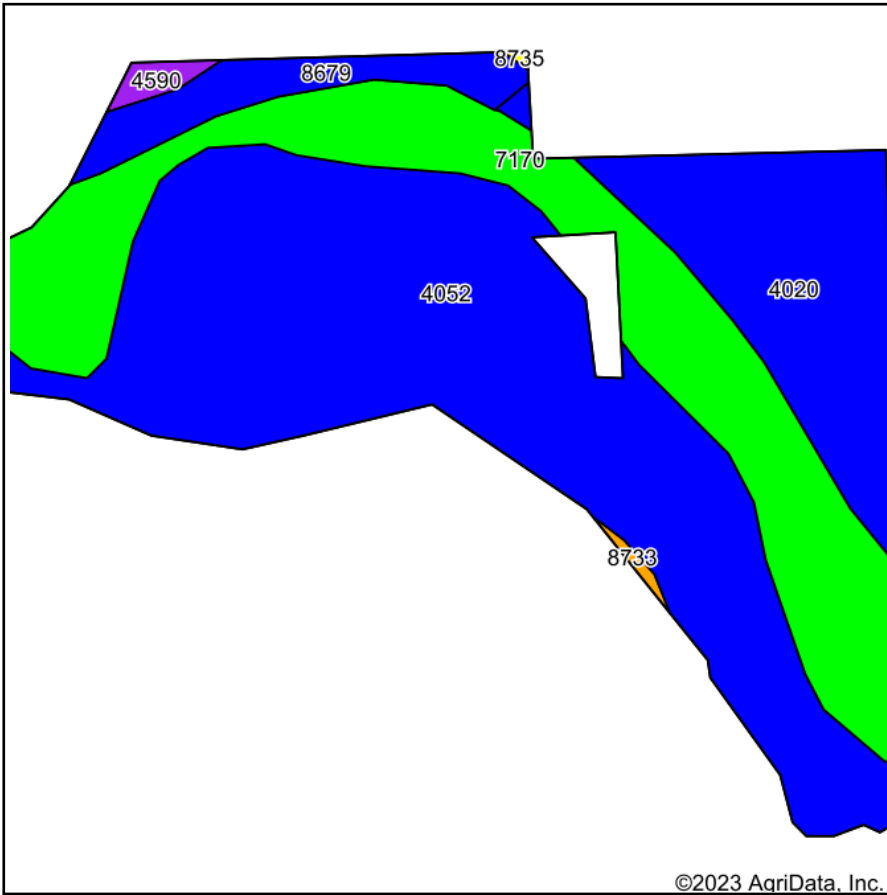

Soils data provided by USDA and NRCS.

Area Symbol: KS073, Soil Area Version: 20

Code	Soil Description	Acres	Percent of field	Non-Irr Class Legend	Non-Irr Class *c	Irr Class *c	Range Production (lbs/acre/yr)	*n NCCPI Overall	*n NCCPI Corn	*n NCCPI Small Grains	*n NCCPI Soybeans	*n NCCPI Cotton
4052	Ivan silt loam, occasionally flooded	29.87	49.2%	[Blue]	Ilw	Ilw	7995	81	64	55	81	51
7170	Reading silt loam, rarely flooded	17.22	28.4%	[Green]	lw	lw	7935	83	82	73	76	55
4020	Chase silty clay loam, occasionally flooded	10.00	16.5%	[Blue]	Ilw	Ilw	7975	67	64	59	66	47
8679	Dennis silt loam, 1 to 3 percent slopes	2.99	4.9%	[Blue]	Ile		4838	78	78	58	64	69
4590	Clime-Sogn complex, 3 to 20 percent slopes	0.46	0.8%	[Purple]	Vle		3225	34	32	32	33	18
8733	Eram silty clay loam, 1 to 3 percent slopes	0.16	0.3%	[Orange]	Ille		4100	54	54	40	39	34
<b>Weighted Average</b>					<b>1.75</b>	<b>*-</b>	<b>7772.8</b>	<b>*n 78.7</b>	<b>*n 69.5</b>	<b>*n 60.7</b>	<b>*n 75.8</b>	<b>*n 52.1</b>

\*n: The aggregation method is "Weighted Average using all components"

\*c: Using Capabilities Class Dominant Condition Aggregation Method

\*- Irr Class weighted average cannot be calculated on the current soils data due to missing data.

Soils data provided by USDA and NRCS.