

Soils Map

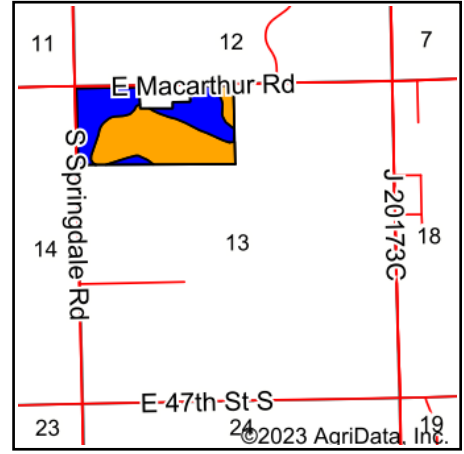

State: **Kansas**
 County: **Sedgwick**
 Location: **13-28S-2E**
 Township: **Gypsum**
 Acres: **71.71**
 Date: **12/20/2023**

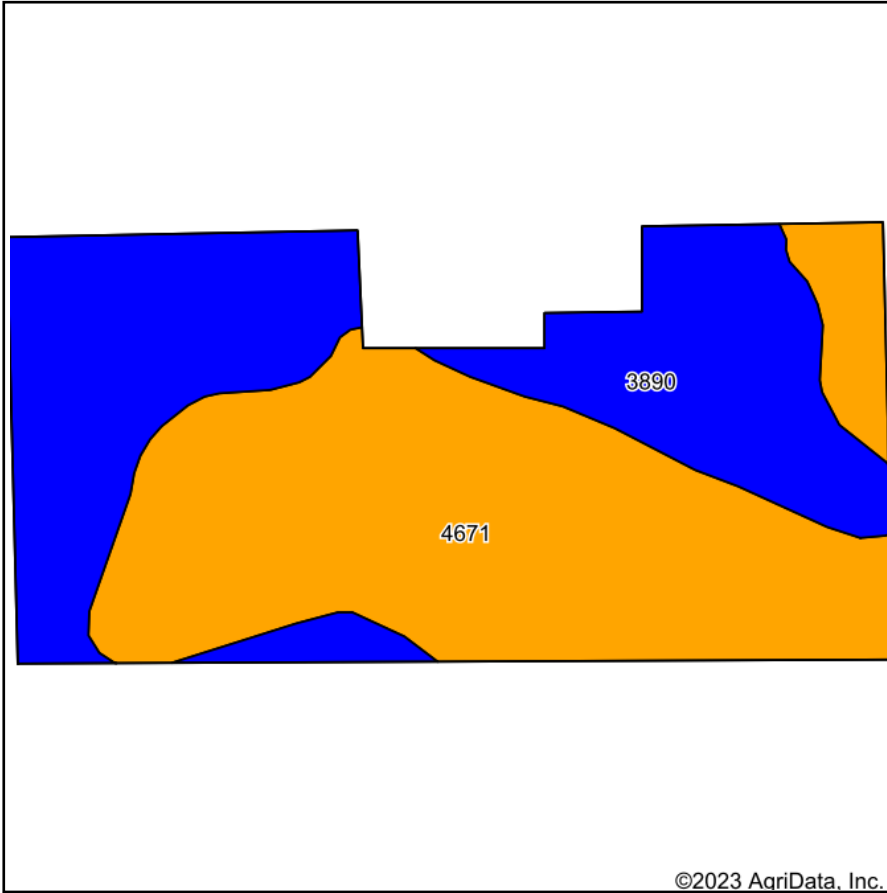

Soils data provided by USDA and NRCS.

©2023 AgriData, Inc.

Area Symbol: KS173, Soil Area Version: 19

Code	Soil Description	Acres	Percent of field	Non-Irr Class Legend	Non-Irr Class *c	Irr Class *c	Range Production (lbs/acre/yr)	*n NCCPI Overall	*n NCCPI Corn	*n NCCPI Small Grains	*n NCCPI Soybeans	*n NCCPI Cotton
4671	Irwin silty clay loam, 1 to 3 percent slopes	39.63	55.3%		IIIs	IIIs	3585	56	45	54	55	40
3890	Ladysmith silty clay loam, 0 to 1 percent slopes	32.08	44.7%		IIs	IIs	3525	52	39	52	51	28
Weighted Average					2.55	2.55	3558.2	*n 54.2	*n 42.3	*n 53.1	*n 53.2	*n 34.6

*n: The aggregation method is "Weighted Average using all components"

*c: Using Capabilities Class Dominant Condition Aggregation Method

Soils data provided by USDA and NRCS.