

Soils Map

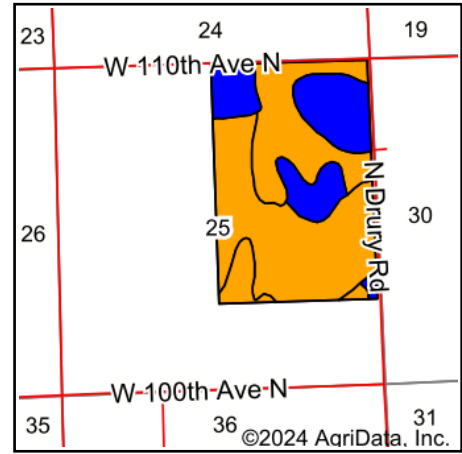

State: **Kansas**
 County: **Sumner**
 Location: **25-30S-2W**
 Township: **Illinois**
 Acres: **226.86**
 Date: **2/23/2024**

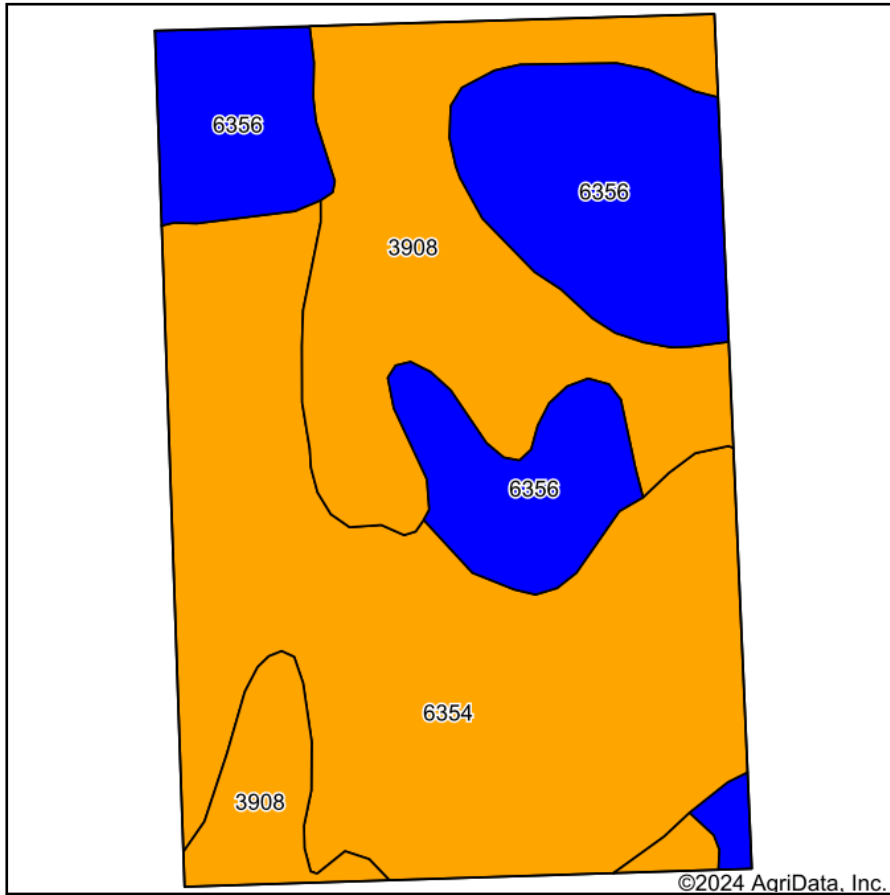

Soils data provided by USDA and NRCS.

©2024 AgriData, Inc.

© AgriData, Inc. 2023

www.AgriDataInc.com

Area Symbol: KS191, Soil Area Version: 20

Code	Soil Description	Acres	Percent of field	Non-Irr Class Legend	Non-Irr Class *c	Irr Class *c	Range Production (lbs/acre/yr)	Barley Bu	Cotton lint Lbs	Grain sorghum Bu	Improved bermudagrass AUM	Introduced bluestem AUM	Oats Bu	Sorghum hay Tons	Wheat Bu
6354	Kirkland silt loam, 0 to 1 percent slopes, cool	100.41	44.3%		Ills	Ills	3890	4	22	35	4	5	34	5	34
3908	Rosehill clay loam, 1 to 3 percent slopes	66.19	29.2%		Ille	Ille	3506								
6356	Kirkland silt loam, 1 to 3 percent slopes	60.26	26.6%		Ils	Ils	3926	2	50	34	4	5	32	5	33
Weighted Average					2.73	2.73	3787.5	2.3	23	24.5	2.8	3.5	23.5	3.5	23.8

*n: The aggregation method is "Weighted Average using all components"

*c: Using Capabilities Class Dominant Condition Aggregation Method

Soils data provided by USDA and NRCS.