

Soils Map

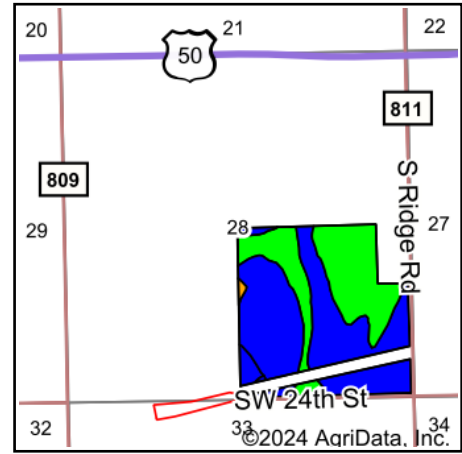

State: **Kansas**
 County: **Harvey**
 Location: **28-23S-1W**
 Township: **Macon**
 Acres: **134.73**
 Date: **3/14/2024**

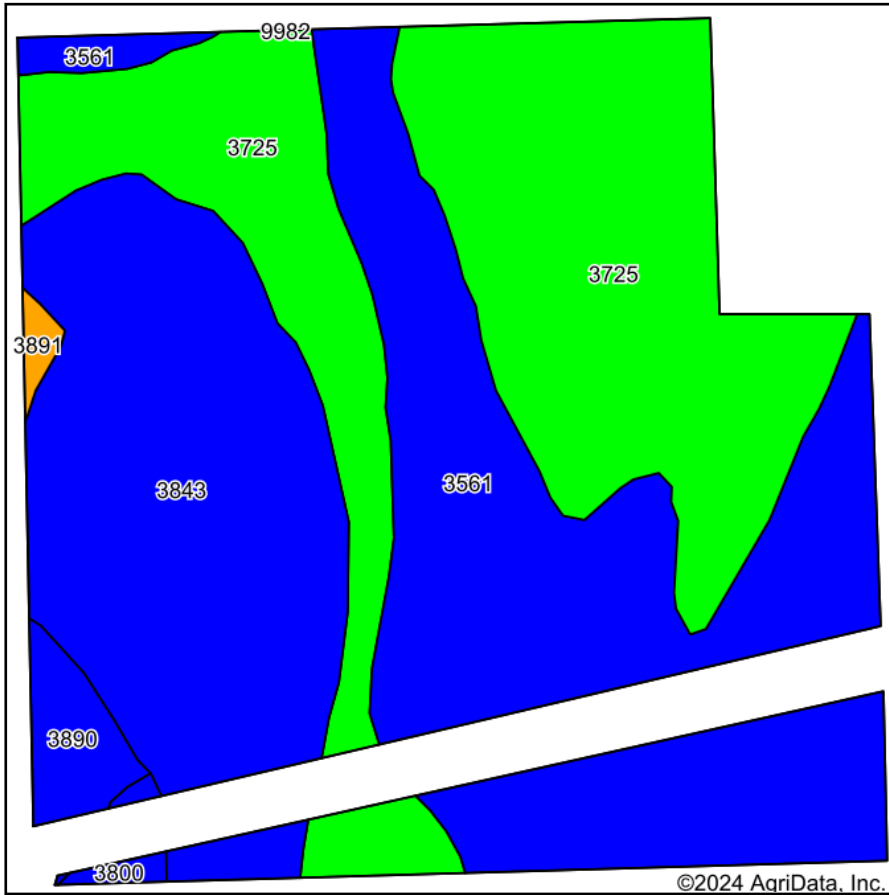

Maps Provided By:



Area Symbol: KS079, Soil Area Version: 20

Code	Soil Description	Acres	Percent of field	Non-Irr Class Legend	Non-Irr Class *c	Irr Class *c	Range Production (lbs/acre/yr)	*n NCCPI Overall	*n NCCPI Corn	*n NCCPI Small Grains	*n NCCPI Soybeans	*n NCCPI Cotton
3725	Detroit silty clay loam, rarely flooded	51.78	38.4%		lw	lw	4620	65	54	60	65	40
3561	Hobbs silt loam, occasionally flooded	44.11	32.7%		llw	llw	5845	79	68	61	79	37
3843	Geary silt loam, 1 to 3 percent slopes	34.57	25.7%		lle	lle	4040	71	68	65	71	36
3890	Ladysmith silty clay loam, 0 to 1 percent slopes	3.04	2.3%		lls	lls	3525	52	39	52	51	28
3800	Crete silt loam, 0 to 1 percent slopes, loess plains and breaks	0.63	0.5%		lls	lls	3580	65	57	61	65	37
3891	Ladysmith silty clay loam, 1 to 3 percent slopes	0.60	0.4%		llls	llls	3525	52	39	52	51	28
Weighted Average					1.62	1.62	4837.8	*n 70.8	*n 61.8	*n 61.4	*n 70.7	*n 37.7

*n: The aggregation method is "Weighted Average using all components"

*c: Using Capabilities Class Dominant Condition Aggregation Method