

# Soils Map

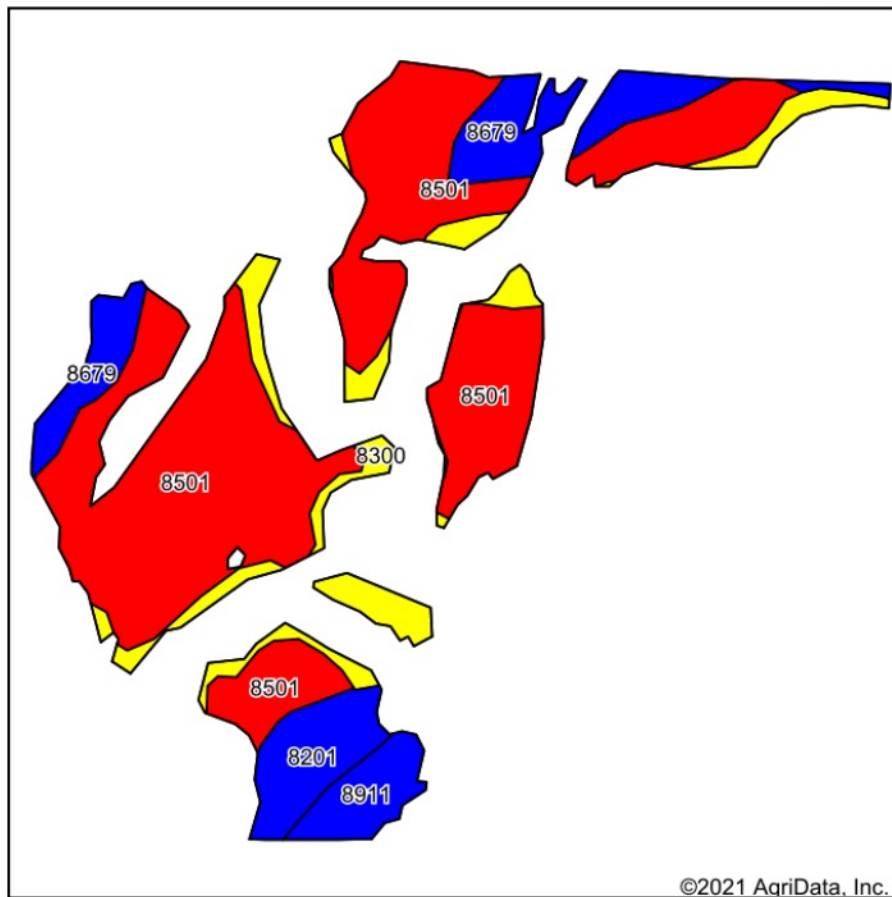

Soils data provided by USDA and NRCS.

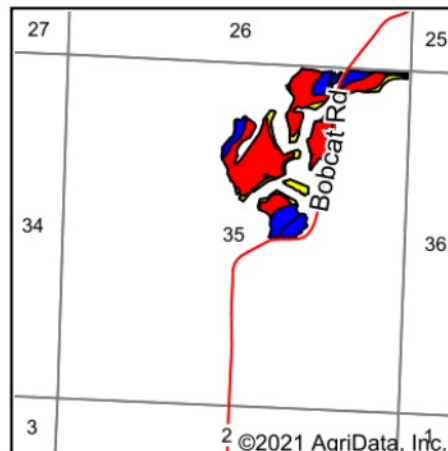

State: **Kansas**  
 County: **Woodson**  
 Location: **35-24S-13E**  
 Township: **Toronto**  
 Acres: **46.86**  
 Date: **6/14/2021**



Area Symbol: KS207, Soil Area Version: 19						
Code	Soil Description	Acres	Percent of field	Non-Irr Class Legend	Non-Irr Class *c	*n NCCPI Soybeans
8501	Mason silt loam, 0 to 1 percent slopes, rarely flooded	30.32	64.7%		Iw	70
8300	Verdigris silt loam, channeled, 0 to 2 percent slopes, frequently flooded	5.84	12.5%		Vw	39
8679	Dennis silt loam, 1 to 3 percent slopes	5.62	12.0%		Ile	64
8201	Osage silty clay loam, 0 to 1 percent slopes, occasionally flooded	3.00	6.4%		Ilw	43
8911	Summit silty clay loam, 1 to 3 percent slopes	2.08	4.4%		Ile	60
Weighted Average						*n 63.2

\*n: The aggregation method is "Weighted Average using all components"

\*c: Using Capabilities Class Dominant Condition Aggregation Method

Soils data provided by USDA and NRCS.