

# Soils Map

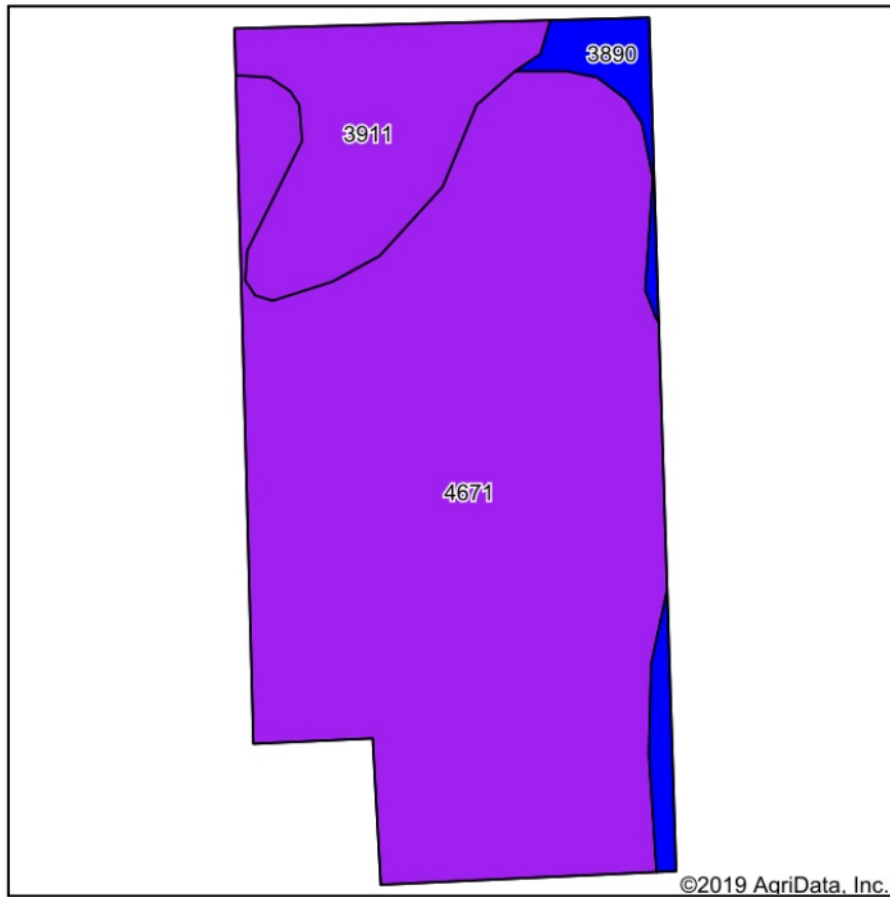

Soils data provided by USDA and NRCS.

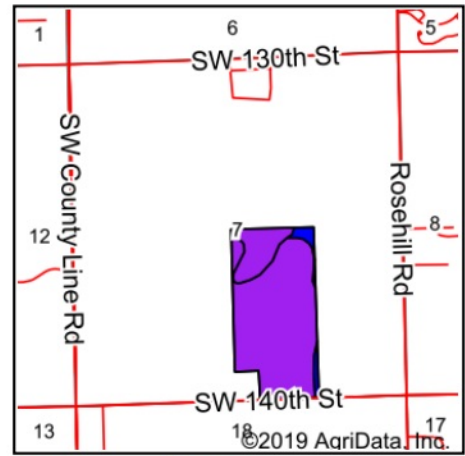

State: **Kansas**  
 County: **Butler**  
 Location: **7-28S-3E**  
 Township: **Pleasant**  
 Acres: **74.36**  
 Date: **11/19/2019**



Area Symbol: KS015, Soil Area Version: 17							
Code	Soil Description	Acres	Percent of field	Non-Irr Class Legend	Non-Irr Class *c	Irr Class *c	*n NCCPI Soybeans
4671	Irwin silty clay loam, 1 to 3 percent slopes	60.60	81.5%		IIIIs	IIIIs	57
3911	Rosehill silty clay, 1 to 3 percent slopes	10.72	14.4%		IIIe	IIIe	27
3890	Ladysmith silty clay loam, 0 to 1 percent slopes	3.04	4.1%		IIIs	IIIs	52
Weighted Average							*n 52.5

\*n: The aggregation method is "Weighted Average using major components"

\*c: Using Capabilities Class Dominant Condition Aggregation Method

Soils data provided by USDA and NRCS.