

Soils Map

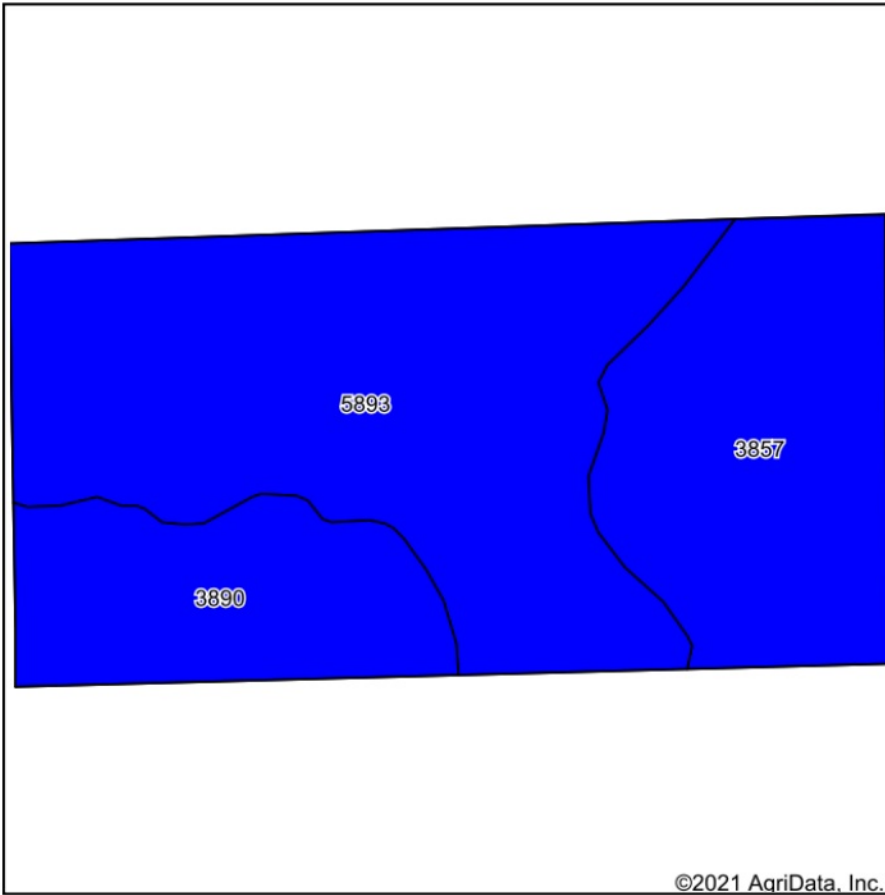

Soils data provided by USDA and NRCS.

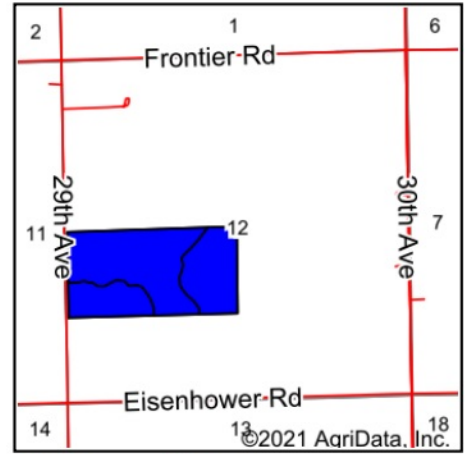

State: **Kansas**
 County: **McPherson**
 Location: **12-20S-1W**
 Township: **Spring Valley**
 Acres: **79.53**
 Date: **12/2/2021**



Area Symbol: KS113, Soil Area Version: 19

Code	Soil Description	Acres	Percent of field	Non-Irr Class Legend	Non-Irr Class *c	Irr Class *c	*n NCCPI Soybeans
5893	Farnum loam, 1 to 3 percent slopes	42.32	53.2%		IIc	IS	64
3857	Goessel silty clay, 0 to 1 percent slopes	22.63	28.5%		IIs	IIs	49
3890	Ladysmith silty clay loam, 0 to 1 percent slopes	14.58	18.3%		IIs	IIs	52
Weighted Average					2.00	1.47	*n 57.5

*n: The aggregation method is "Weighted Average using all components"

*c: Using Capabilities Class Dominant Condition Aggregation Method