

160+- ACRES GREENWOOD COUNTY KANSAS LAND
FOR SALE

AUCTION

www.sundgren.com

Thursday, November 16, 2017 • 6:00 P.M.

AUCTION LOCATION: Greenwood Hotel, 300 N. Main, Eureka, KS

CORNERSTONE CHARITABLE FOUNDATION, SELLER



PROPERTY DESCRIPTION: 160+- acres of Flint Hills cattle grazing pasture land. This tract has good fences, good water provided by two ponds, and spring fed draws. The property is cross fenced to utilize rotational grazing, or to allow portions of the property to be utilized for hay or livestock grazing. Improvement include an old homestead and some pipe pens. Excellent property to add to your livestock operation or investment portfolio.

LEGAL DESCRIPTION: The Southeast Quarter (SE4) of Section 11, Township 23 South, Range 10 East of the 6th P.M., Greenwood County, Kansas.

2016 REAL ESTATE TAXES: \$274.30.

LAND LOCATION: From HWY 99 South of Madison, 6 Miles West on 350th, 1 Mile South on R Rd, 1 Mile West on 340th, then 2 1/2 Miles South on Q Rd.



TERMS: Earnest money is \$25,000 due at the conclusion of the Auction, and the balance due upon Sellers submission of merchantable title and closing. Closing date shall be on or before December 18, 2017. Closing fee and title insurance fee will be split 50/50 between Seller and Buyer. Selling subject to easements, restrictions, roadways and rights of way. This property is not selling subject to financing or inspections. Interested buyers need to view the property prior to the date of the auction and have financing available and any inspections performed prior to bidding. All pertinent information is available upon request. All announcements made the day of the auction take precedence over any other announcements or printed material.

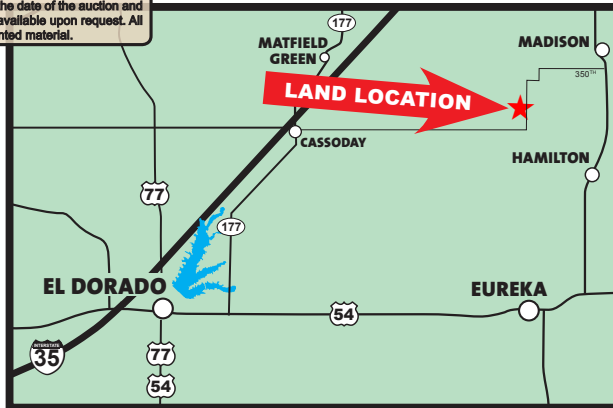

JOE SUNDGREN
BROKER AND AUCTIONEER
316-377-7112

RICK REMSBERG
REALTOR
AND AUCTIONEER
316-322-5391



218 East Central Ave, El Dorado, KS 67042
LAND BROKERS • www.sundgren.com

JEREMY SUNDGREN
ASSOCIATE BROKER
AND AUCTIONEER
316-377-0013

PHILLIP SOLORIO
REALTOR
316-323-0218