

Soils Map

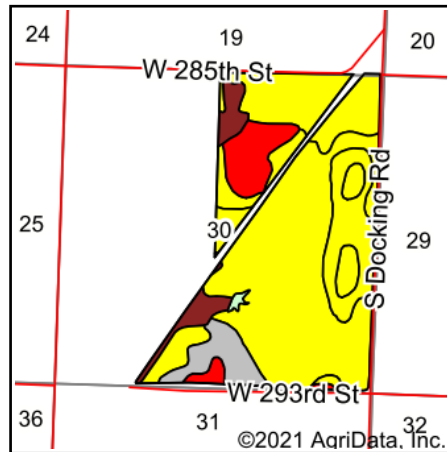

State: **Kansas**
 County: **Osage**
 Location: **30-17S-14E**
 Township: **Barclay**
 Acres: **333.37**
 Date: **12/13/2021**

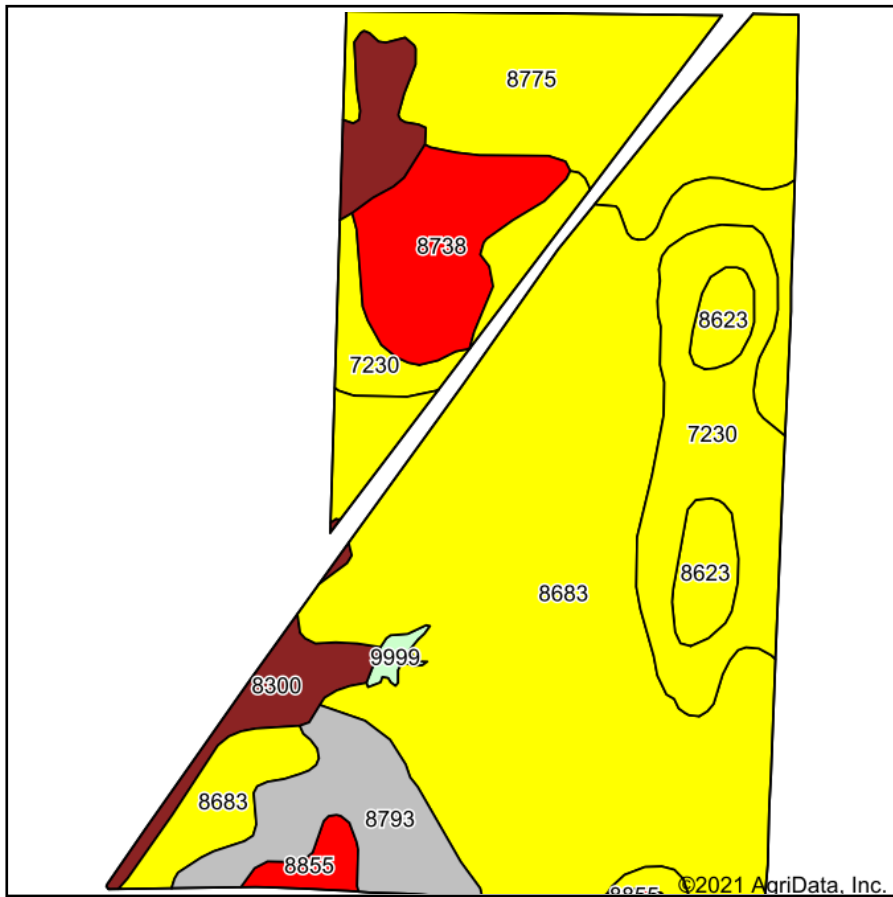

Maps Provided By:
surety
 CUSTOMIZED ONLINE MAPPING
 © AgriData, Inc. 2021 www.AgriDataInc.com



Soils data provided by USDA and NRCS.

Area Symbol: KS139, Soil Area Version: 20

Code	Soil Description	Acres	Percent of field	Non-Irr Class Legend	Non-Irr Class *c	Alfalfa hay Tons	Corn Bu	Grain sorghum Bu	Smooth bromegrass AUM	Soybeans Bu	Winter wheat Bu	*n NCCPI Overall	*n NCCPI Corn	*n NCCPI Small Grains	*n NCCPI Soybeans	*n NCCPI Cotton	
8683	Dennis silt loam, 3 to 7 percent slopes	169.52	50.9%		IIle							77	77	60	66	66	
8775	Kenoma silt loam, 1 to 3 percent slopes	49.07	14.7%		IIle							60	56	56	59	54	
7230	Elmont loam, 3 to 7 percent slopes	39.38	11.8%		IIle	3	68	71		6	27	32	83	83	70	66	47
8738	Eram silty clay, 3 to 7 percent slopes, eroded	21.51	6.5%		IVe							41	41	31	24	14	
8793	Lebo-Summit complex, 8 to 12 percent slopes	19.71	5.9%		VIe							63	63	54	52	31	
8300	Verdigris silt loam, channeled, 0 to 2 percent slopes, frequently flooded	17.20	5.2%		Vw							48	48	27	39	14	
8623	Bates loam, 3 to 7 percent slopes	11.26	3.4%		IIle							63	63	54	49	57	



8855	Olpe-Kenoma complex, 1 to 3 percent slopes	4.38	1.3%		Ive							57	56	50	51	31
9999	Water	1.34	0.4%													
Weighted Average					3.35	0.4	8	8.4	0.7	3.2	3.8	*n 69.5	*n 68.9	*n 56.1	*n 59	*n 52.9

*n: The aggregation method is "Weighted Average using all components"

*c: Using Capabilities Class Dominant Condition Aggregation Method
Soils data provided by USDA and NRCS.