

# Soils Map

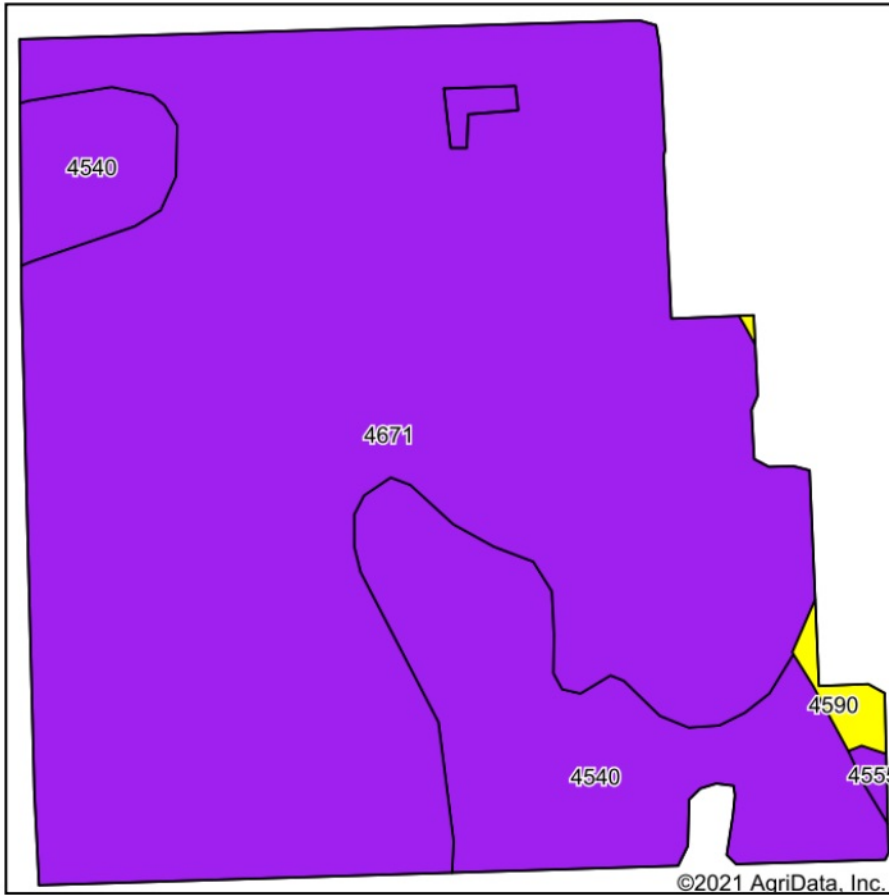

Soils data provided by USDA and NRCS.

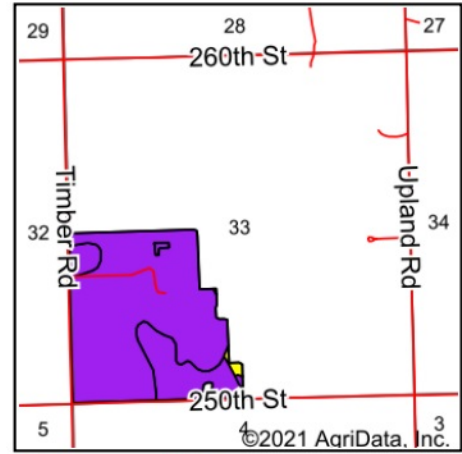

State: **Kansas**  
 County: **Marion**  
 Location: **33-18S-4E**  
 Township: **Clear Creek**  
 Acres: **135.86**  
 Date: **5/17/2021**



Area Symbol: KS115, Soil Area Version: 17

Code	Soil Description	Acres	Percent of field	Non-Irr Class Legend	Non-Irr Class *c	Irr Class *c	*n NCCPI Soybeans
4671	Irwin silty clay loam, 1 to 3 percent slopes	108.65	80.0%		III s	III s	55
4540	Clime silty clay loam, 1 to 3 percent slopes	25.81	19.0%		III e	III e	43
4590	Clime-Sogn complex, 3 to 20 percent slopes	1.07	0.8%		VI e		34
4555	Clime silty clay loam, 3 to 7 percent slopes	0.33	0.2%		III e	III e	43
<b>Weighted Average</b>							<b>*n 52.5</b>

\*n: The aggregation method is "Weighted Average using all components"

\*c: Using Capabilities Class Dominant Condition Aggregation Method