

# Soils Map

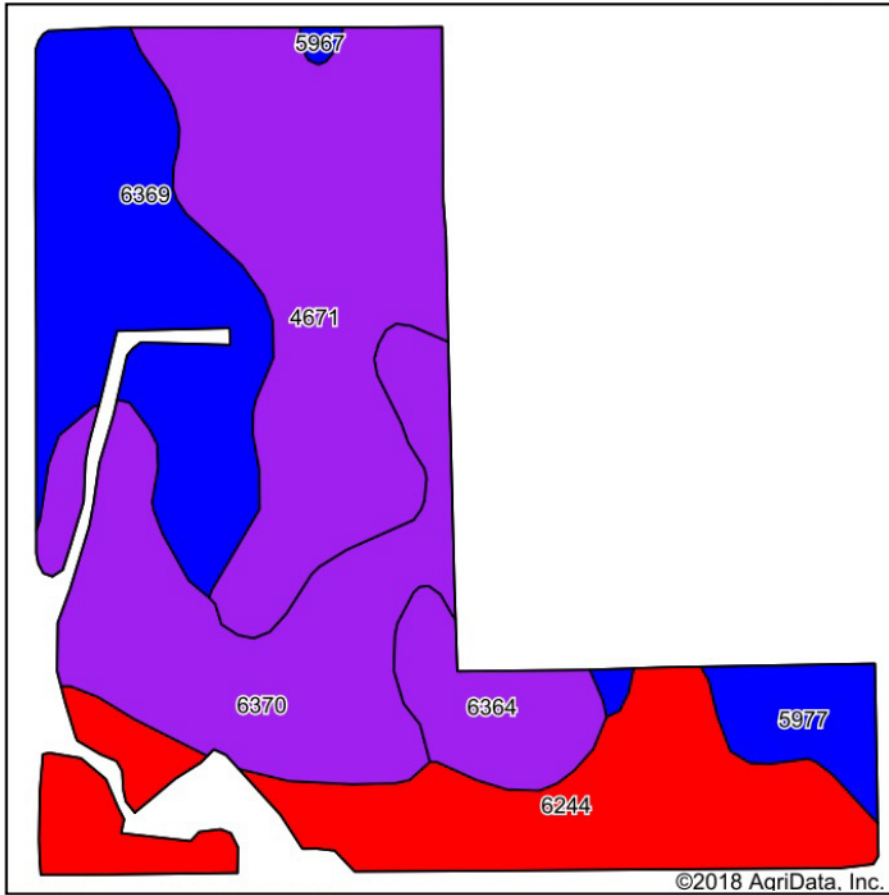

Soils data provided by USDA and NRCS.

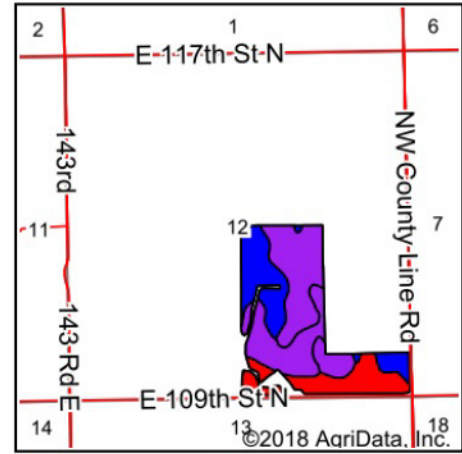

State: **Kansas**  
 County: **Sedgwick**  
 Location: **12-25S-2E**  
 Township: **Lincoln**  
 Acres: **89.54**  
 Date: **10/15/2018**



## Area Symbol: KS173, Soil Area Version: 13

Code	Soil Description	Acres	Percent of field	Non-Irr Class Legend	Non-Irr Class *c	Irr Class *c	Grain sorghum	Grain sorghum Irrigated	Smooth bromegrass	Smooth bromegrass Irrigated	Winter wheat	Alfalfa hay	Alfalfa hay Irrigated	Soybeans	Soybeans Irrigated	Corn Irrigated
4671	Inwin silty clay loam, 1 to 3 percent slopes	24.36	27.2%		Ills	Ills										
6370	Milan loam, 3 to 6 percent slopes	19.25	21.5%		IIIe		53	110	5	10	32					150
6244	Elandco silt loam, rarely flooded	18.89	21.1%		le	le										
6369	Milan loam, 1 to 3 percent slopes	17.60	19.7%		Ile	Ile	58	115	6	9	35	4	7	33	50	
6364	Milan clay loam, 3 to 6 percent slopes, eroded	5.21	5.8%		IIIe		48	105	5	8	28					
5977	Vanoss silt loam, 1 to 3 percent slopes	3.98	4.4%		Ile	Ile										
5967	Tabler silty clay loam, 0 to 1 percent slopes	0.25	0.3%		Ils	Ils										
<b>Weighted Average</b>							<b>25.6</b>	<b>52.4</b>	<b>2.5</b>	<b>4.4</b>	<b>15.4</b>	<b>0.8</b>	<b>1.4</b>	<b>6.5</b>	<b>9.8</b>	<b>32.2</b>

\*c: Using Capabilities Class Dominant Condition Aggregation Method

Soils data provided by USDA and NRCS.